

GENERAL NOTES:

- ALL UNDERGROUND UTILITIES SHALL BE VERIFIED IN THE FIELD WITH THE OWNER OR GENERAL CONTRACTOR PRIOR TO THE COMMENCEMENT OF ANY DIGGING OPERATIONS. IN THE EVENT THEY ARE UNCOVERED, THE LANDSCAPE CONTRACTOR SHALL BE HELD RESPONSIBLE FOR ALL DAMAGE TO UTILITIES AND SUCH DAMAGE SHALL NOT RESULT IN ANY ADDITIONAL EXPENSES TO THE OWNER.
- EVERY POSSIBLE SAFEGUARD SHALL BE TAKEN TO PROTECT BUILDING SURFACES, EQUIPMENT, AND FURNISHING. THE CONTRACTOR SHALL BE RESPONSIBLE FOR ANY DAMAGE OR INJURY TO PERSONNEL OR PROPERTY WHICH MAY OCCUR AS A RESULT OF HIS NEGLIGENCE IN THE EXECUTION OF THE WORK.
- IN THE EVENT OF VARIATION BETWEEN QUANTITIES SHOWN ON THE PLANT LIST AND THE PLANS, THE PLANS SHALL CONTROL. THE CONTRACTOR IS RESPONSIBLE FOR VERIFYING ALL PLANT QUANTITIES PRIOR TO THE COMMENCEMENT OF WORK. SOD QUANTITY TAKE-OFFS ARE THE RESPONSIBILITY OF THE CONTRACTOR. THE CONTRACTOR SHALL FURNISH PLANT MATERIAL IN SIZES AS SPECIFIED IN PLANT LIST.
- PLANTS SHALL CONFORM TO CURRENT "AMERICAN STANDARDS FOR NURSERY STOCK" BY AMERICAN ASSOCIATION OF NURSERYMAN (AAN), PARTICULARLY WITH REGARD TO SIZE, GROWTH, SIZE OF BALL, AND DENSITY OF BRANCH STRUCTURE. REFERENCE "ANSI Z60.1-2004 (OR MOST CURRENT DOCUMENT AVAILABLE AT WWW.ANLA.ORG).
- ALL PLANTS (B&B OR CONTAINER) SHALL BE PROPERLY IDENTIFIED BY WEATHER-PROOF LABELS, SECURELY ATTACHED THERETO BEFORE DELIVERY TO PROTECT SITE. LABELS SHALL IDENTIFY PLANTS BY NAME, SPECIES, AND SIZE. LABELS SHALL NOT BE REMOVED UNTIL THE FINAL INSPECTION BY THE OWNER.
- NO SUBSTITUTIONS SHALL BE MADE WITHOUT WRITTEN CONSENT OF THE OWNER OR LANDSCAPE ARCHITECT.
- NO INVASIVE SPECIES ALLOWED, NATIVE SPECIES PREFERRED.
- THE CONTRACTOR SHALL BE WHOLLY RESPONSIBLE FOR STABILITY AND CONDITIONS OF ALL TREES AND SHRUBS AND SHALL BE LEGALLY LIABLE FOR ANY DAMAGE CAUSED BY INSTABILITY OF ANY PLANT MATERIALS.
- ALL PLANTING BEDS SHALL BE MULCHED WITH HARDWOOD MULCH AS SPECIFIED, UNLESS OTHERWISE DIRECTED.
- ALL PLANT MATERIAL SHALL BE GUARANTEED FOR TWELVE MONTHS FROM THE DATE OF ACCEPTANCE. WATERING SHALL BE THE RESPONSIBILITY OF THE CONTRACTOR DURING CONSTRUCTION. UPON COMPLETION, THE CONTRACTOR SHALL INFORM THE OWNER OF WATERING REQUIREMENTS AND GENERAL MAINTENANCE OF THE INSTALLED LANDSCAPING IN ORDER TO REALIZE HIGHER ESTABLISHMENT RATES.
- PLANTING BEDS AND TREE PITS SHALL BE AMENDED AND TILLED TO A MINIMUM 6 INCH DEPTH. ALL PLANTING BEDS SHALL BE $\frac{1}{3}$ PARENT MATERIAL, $\frac{1}{3}$ ORGANIC MATERIAL, AND $\frac{1}{3}$ TOP SOIL, FREE OF DEBRIS AND STONES LARGER THAN $\frac{1}{2}$ " DIA.

RECOMMENDED PLANTING LIST

ID	QTY	BOTANICAL NAME	COMMON NAME	SIZE	NOTES
TREES					
CC	2	CERCIS CANADENSIS	EASTERN REDBUD	7'-8' hgt	NATIVE
IX	2	ILEX X 'CONAF'	OAK LEAF RED HOLLY	4'-5' hgt	
MV	1	MAGNOLIA VIRGINIANA	SWEETBAY MAGNOLIA	7'-8' hgt	NATIVE
PS	3	PINUS STROBUS	EASTERN WHITE PINE	5'-6' hgt	NATIVE
QP	1	QUERCUS PHELLOS	WILLOW OAK	2" cal.	NATIVE
SHRUBS					
BX	22	BUXUS X 'GREEN VELVET'	GREEN VELVET BOXWOOD	24"-30"ht	
CD	11	COTONEASTER DAMERII	CORAL BEAUTY COTONEASTER	24"-30"sp	GROUNDCOVER
HF	2	HYPERICUM FRONDOSUM	SUNBURST ST JOHNS WORT	24"-30"	
HP	1	HYD. PANICULATA SMHPCW	STRAWBERRY SHAKE HYD.	24"-30"ht	
IC	3	ILEX CRENATA 'SKY PENCIL'	SKY PENCIL HOLLY	30"-36" ht	
MD	4	M. DECUSATTA 'CONDREW'	DREW'S BLUE CARPET CYPRESS	18"-24"sp	
PERENNIALS/GRASSES/GROUNDCOVERS					
CA	26	C. ACUTIFOLIA 'KARL FOERSTER'	K. FOERSTER FEATHER REED GRASS	CONT.	NATIVE HYBRID
CV	7	COREOPSIS VERTICILATTA	THREADLEAF TICKSEED	CONT.	NATIVE
GL	14	GAURA LINDHEIMERII	WHITE GAURA	CONT.	
HH	15	HELLEBORUS X HYBRIDUS	SPARKLING DIAMOND HELLEBORE	CONT.	EVERGREEN
NF	4	NEPETA FAASSENII	WALKERS LOW CATMINT	CONT.	
PA	15	P. ALOPECUROIDES 'HAMELN'	DWARF FOUNTAIN GRASS	CONT.	
PS	6	PENNISETUM SETACEUM RUBRUM	PURPLE FOUNTAIN GRASS	CONT.	
RF	5	RUDBECKIA FULGIDA	BLACK-EYED SUSAN	CONT.	NATIVE

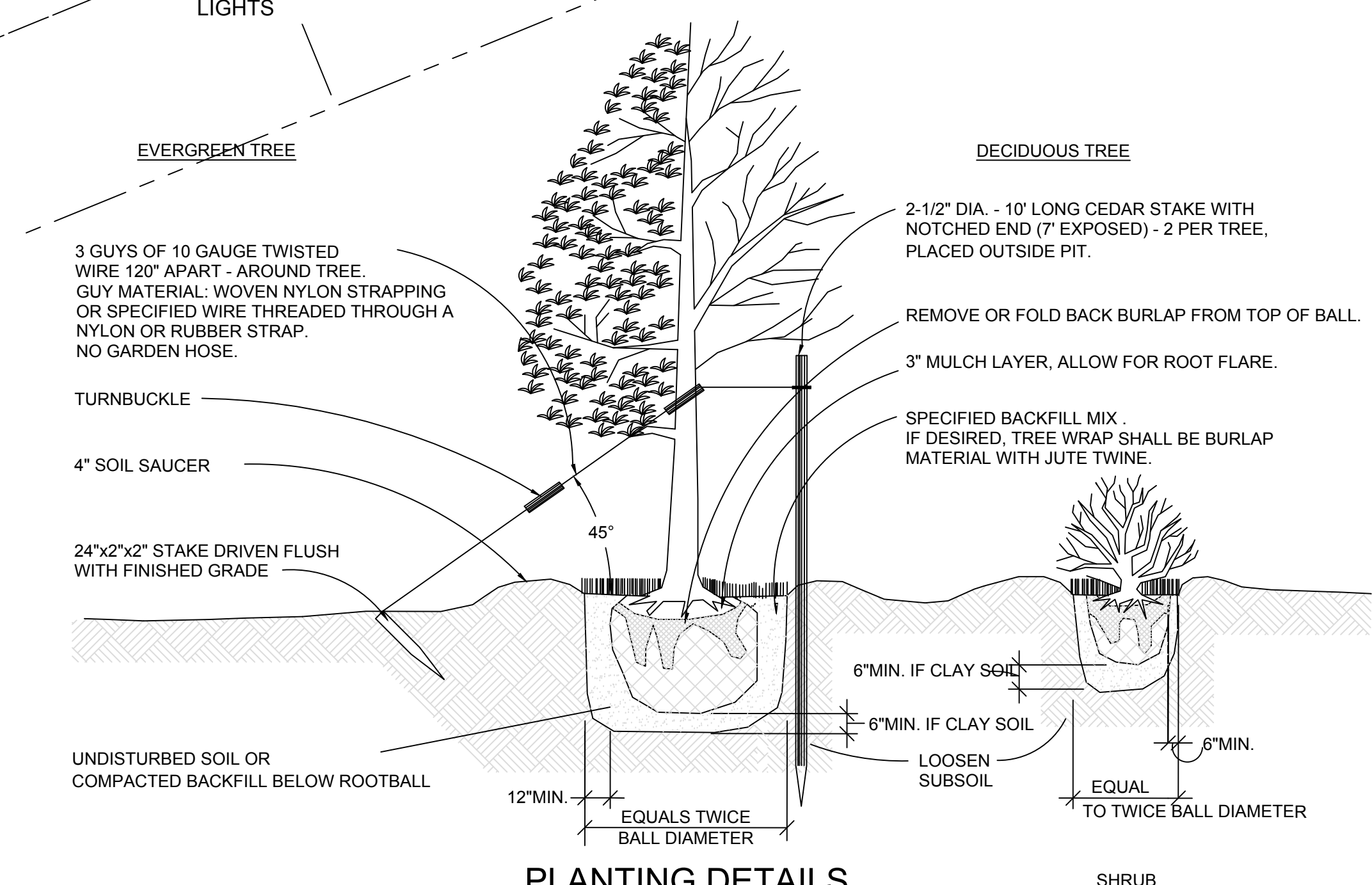
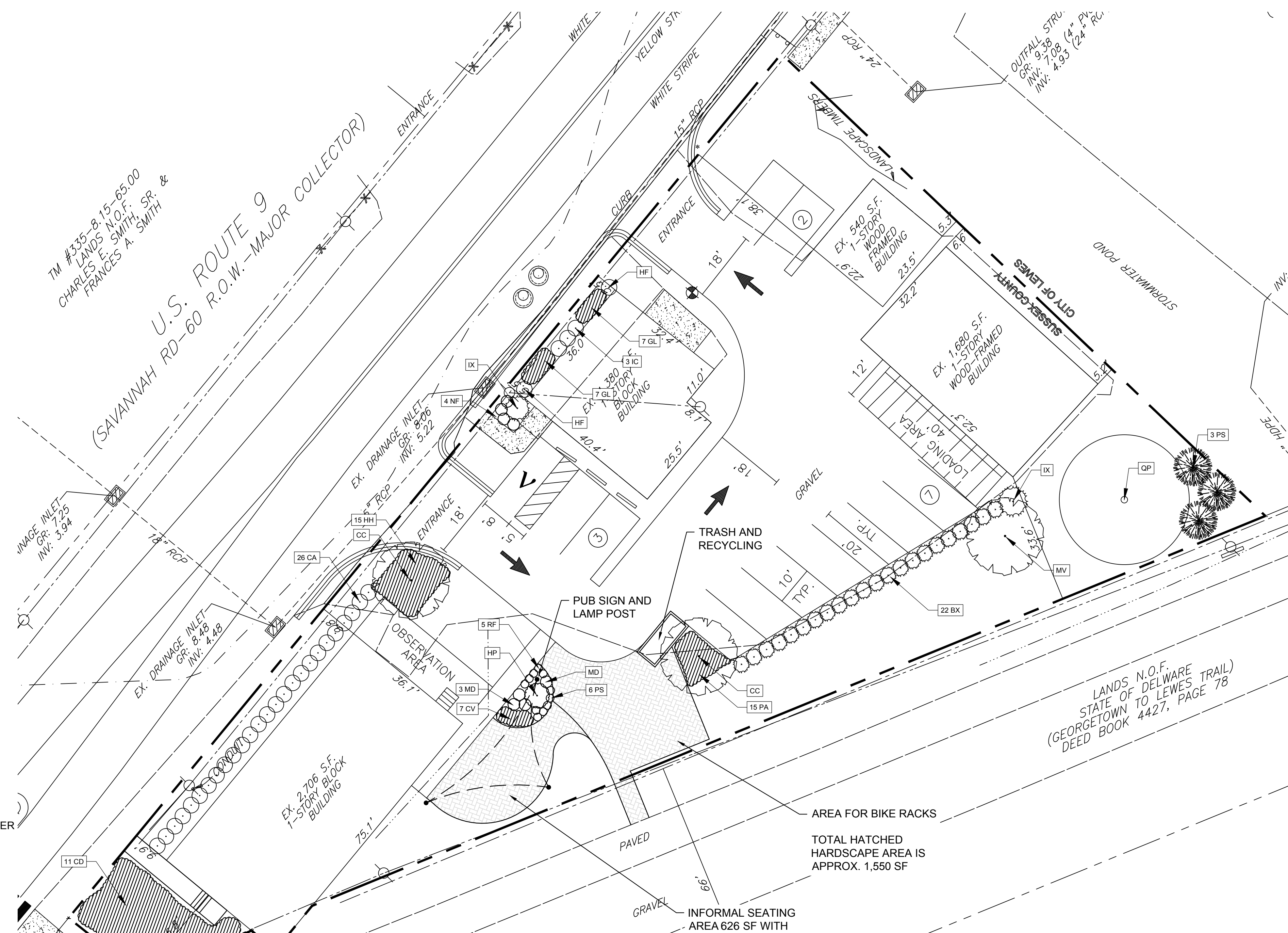

PLANTING DETAILS

Pennoni
 PENNONI ASSOCIATES INC.
 18072 Davidson Drive
 Milton, DE 19968
 T 302.684.8030 F 302.684.8054

ALL DIMENSIONS MUST BE VERIFIED BY CONTRACTOR AND OWNER MUST BE NOTIFIED OF ANY DISCREPANCIES BEFORE PROCEEDING WITH WORK

LEWES BREWING COMPANY
 TAX ID 335-6-15-39-01
 LEWES, DELAWARE

LANDSCAPE PLAN

ELEMENT DESIGN GROUP
 115 W. MARKET STREET
 LEWES, DE 19958

NO.	DATE	BY	REVISIONS

ALL DOCUMENTS PREPARED BY PENNONI ASSOCIATES ARE INSTRUMENTS OF SERVICE IN RESPECT OF THE PROJECT. THEY ARE NOT INTENDED OR REPRESENTED TO BE SUITABLE FOR REUSE BY OWNER OR OTHERS ON THE EXTENSIONS OF THE PROJECT OR ON ANY OTHER PROJECT. ANY REUSE WITHOUT WRITTEN VERIFICATION OR ADAPTATION BY PENNONI ASSOCIATES FOR THE SPECIFIC PURPOSE INTENDED WILL BE AT OWNERS SOLE RISK AND WITHOUT LIABILITY OR LEGAL EXPOSURE TO PENNONI ASSOCIATES AND OWNER SHALL INDEMNIFY AND HOLD HARMLESS PENNONI ASSOCIATES FROM ALL CLAIMS, DAMAGES, LOSSES AND EXPENSES ARISING OUT OF OR RESULTING THEREFROM.

PROJECT	ETDGX21011
DATE	2021-09-29
DRAWING SCALE	1"=16'-0"
DRAWN BY	EWW
APPROVED BY	EWW